

Deck valve anti-clockwise closing hot - Brushed Platinum



CL.1

20 000 741

- hole diameter 32 mm
- handle Ø 60mm
- without rosette
- with hot marking



Fits: CL.1, CYO

|   |                                     |               |
|---|-------------------------------------|---------------|
|  | Brushed Platinum                    | 20 000 741-06 |
|  | Chrome                              | 20 000 741-00 |
|  | Dark Chrome                         | 20 000 741-19 |
|  | Brushed Durabronze<br>(23kt Gold)   | 20 000 741-28 |
|  | Matte Black                         | 20 000 741-33 |
|  | Brushed<br>Champagne (22kt<br>Gold) | 20 000 741-46 |
|  | Champagne (22kt<br>Gold)            | 20 000 741-47 |
|  | Brushed Dark<br>Platinum            | 20 000 741-99 |

20 000 741

mm [inches]

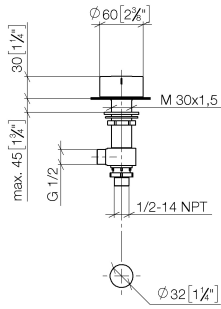

Flow rate chart



Certificates

IAPMO\_4976 (5). WRAS\_2103001. LGA\_28688.

20 000 741

Parts for other finishes can be found here: [Chrome](#)

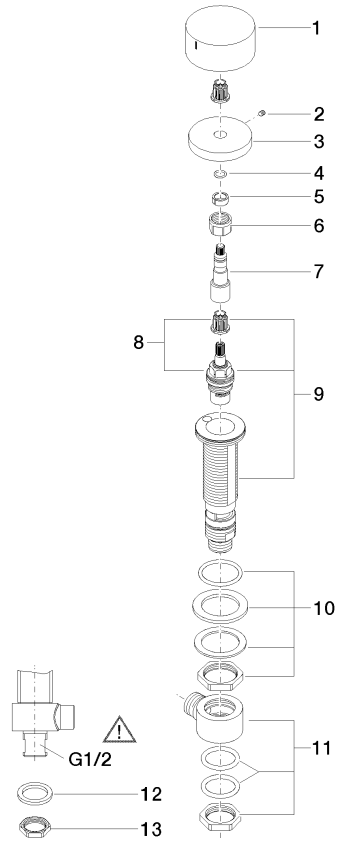

**Spare parts list**

| No. | Item Number        | Name           | Quantity used | Delivery time |
|-----|--------------------|----------------|---------------|---------------|
| 1   | 09 20 74 006-06    | handle ( hot ) | 1             | 10            |
| 2   | 90 31 11 007 00 90 | pin            | 1             | 2             |
| 3   | 09 27 74 003-06    | rosette        | 1             | 10            |
| 4   | 90 14 10 060 00 90 | seal           | 1             | 2             |
| 5   | 90 14 15 020 03 90 | ring           | 1             | 2             |
| 6   | 90 23 30 023 00 90 | nut            | 1             | 2             |
| 7   | 09 29 06 107-00    | spindle        | 1             | 10            |
| 8   | 90 90 03 132 00 90 | top            | 1             | 2             |
| 9   | 04 17 11 058 32 90 | side panel     | 1             | 2             |
| 10  | 04 23 10 032 78 90 | fixing set     | 1             | 2             |
| 11  | 04 17 11 023 10 90 | distributor    | 1             | 2             |
| 12  | 09 30 11 059 90    | disc           | 1             | 2             |
| 13  | 09 23 10 012 90    | nut            | 1             | 2             |